



Artistico
Furniture

PRODUCT TECHNICAL SHEET

Quattro Counter

Standard's general scheme

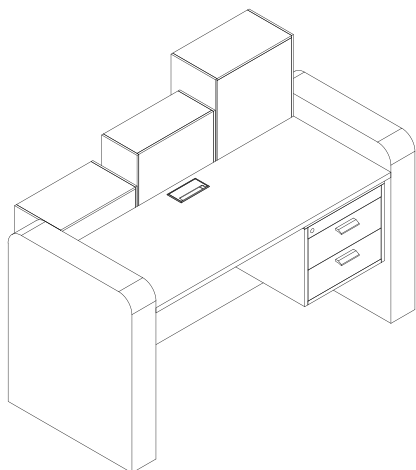

QCO40102

(1)

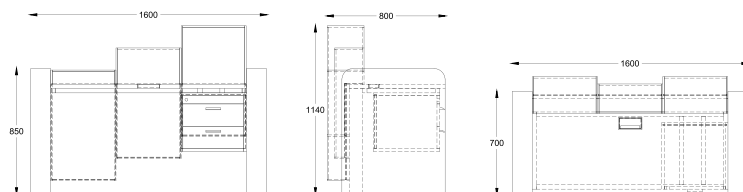

Counter (1)		
Overall dimensions		Measurements
(mm)		
Height	H	1150
Width	L	1600
Depth	P	800

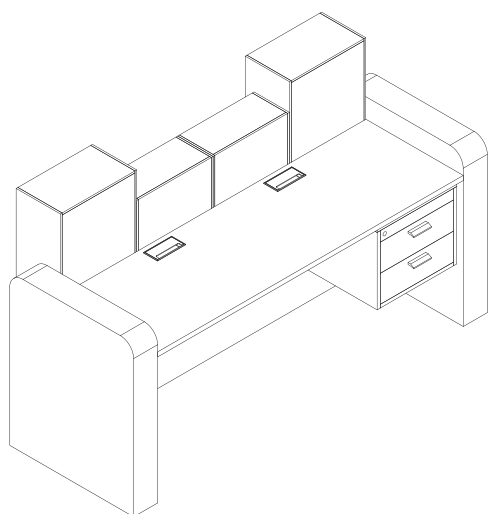

QCO40103

(2)

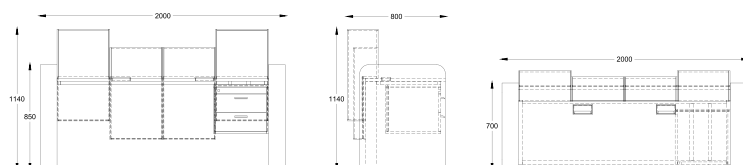

Counter (2)		
Overall dimensions		Measurements
(mm)		
Height	H	1150
Width	L	2000
Depth	P	800

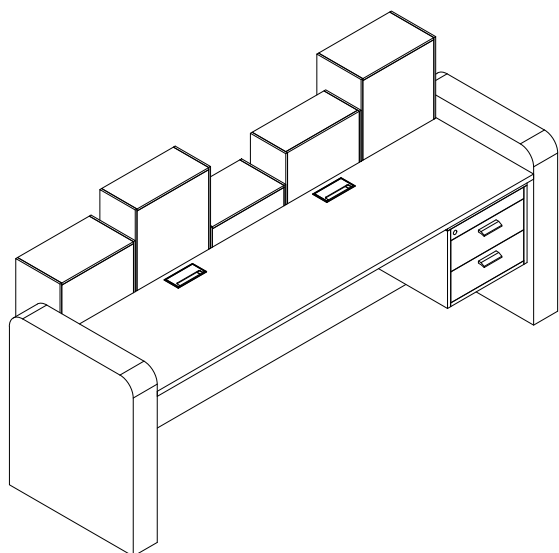

QCO40104

(3)

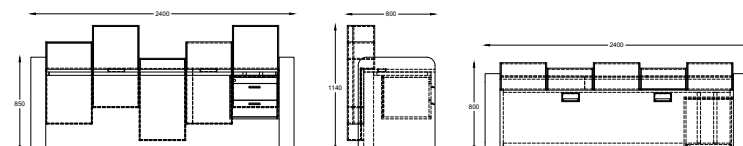

Counter (3)		
Overall dimensions		Measurements
(mm)		
Height	H	1150
Width	L	2400
Depth	P	800

DESCRIPTION

Body : constructed of beech pine wood slats covered with MDF 8mm thickness Coated With Polyurthane Paint to provide a durable, water-resistant finish.

Top : 18 mm thickness MDF .

Chassis : Steel coated with Electrostatic paint.

Cut : By CNC

Surface : Melamine board which is anti-scratch. bacteria, water and heat resistance.

Edges : PVC 2 mm thickness.

Accessories :

- Rectangular Metal brush grommet.
- Provided with reglash to adjust desk balance.

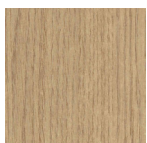

wood

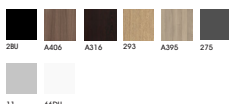

LINEN

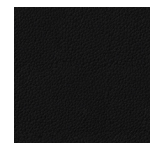
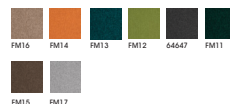

LEATHER

